

Update from the Campaign Committee about the Redevelopment at
North Wellington Health Care - Louise Marshall Hospital

August 2014



Update from Campaign Chair Dr. Bob McFarlane

My purpose in writing today is to keep you connected to one of the most compelling developments in our community's health care history - the Redevelopment of the Emergency Department and Ambulatory Care area at Louise Marshall Hospital.

Since the last *Campaign Link*, we have news from the Ministry of Health and Long Term Care (the Ministry); a major development; and a major gift commitment.

News from the Ministry

President and CEO of North Wellington Health Care Jerome Quenneville advised our Campaign Committee that the Ministry has begun dialogue again with the hospital regarding the Redevelopment. Following changes at the Ministry and then a provincial election, Ministry staff wanted to revisit some of the earlier plans that had been submitted. Other than minor changes, our current plan still illustrates the best option. The Ministry requires more information and details, but for now, this is great news after a seven month communication hiatus.

One of the Ministry's requirements is a request of the Foundation in three areas: the status of commitments, stewardship and restriction of funds for this sole purpose of supporting the Redevelopment. The Foundation already is well on the way with its funding. I would like to **THANK YOU** most sincerely

for coming on board with the Campaign in the past 15 months; the Foundation can confidently say "yes, our community is financially committed." Rest assured, the Foundation is diligently keeping proper records to show that funds received to date - now over \$800,000 - are being responsibly invested securely and restricted in use until needed.

"Developing" News

This leads me to the second point - the major development. In June, the Hospital Board gave approval to begin a multi-stage renovation as a "pre-Redevelopment" project. You may be asking, "Why in the world would they begin another project?"

Well, actually it is all connected. Before the Redevelopment can begin in the Ambulatory Care area [see *Proposed Concept Floor Plan - light green area - in the inset*], the offices

used by specialists and spaces like waiting rooms are to be shifted. Hospital staff understand the logistics of this better than I do (*I am one of those visiting specialists who use the operating room*). So kudos to the Hospital Board and staff for getting things rolling!

Major Support Approved by the County

And lastly...my big announcement is that Wellington County Council has approved supporting our Campaign with a future gift of \$1.2 million. And even better still, the treasurer at the County had it all worked out that only minimal or no tax dollars would be required (*I am a tax payer in Wellington County, too!*). We await official notice from the County to

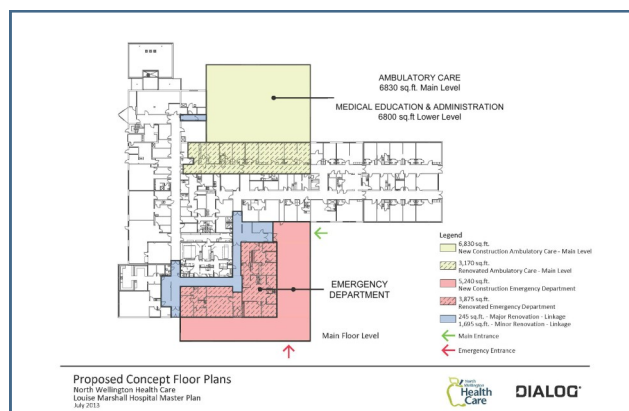

include the amount in the Campaign goal. But for today, it is very encouraging to have such good news about this County gift at this stage in the Campaign.

Some comments the Campaign Committee has heard from the general public include concern that our local governments were not supporting our Campaign. The County gift proves that they are! Health of constituents is important to our County Councillors.

And one final remark: if you are inclined to help

this Campaign beyond your financial support, one way is to tell others why you support the Campaign. Future supporters act on advice from trusted friends ahead of being approached by people they don't know. By putting it in your own words, you will help our Campaign Committee of eight people who are stretching to reach 15,000 people in two years time.

Thanks for all your help!



Helping

the Always Here for You Campaign

...Beyond your financial support

As Dr McFarlane mentioned in his message above, the Campaign Committee is looking for your help.

Several of our key supporters have been very successful working behind the scenes talking to friends and family about the Campaign. These "unofficial" volunteers of the Campaign are making a big difference. **Thank you so much!** If you know someone is interested, please contact the Foundation office and tell us how we can help. It gives us an opportunity to share with new businesses and fami-

lies about the Campaign.

Are you involved in a group? Whether at church, in the community, or just a group of friends coming together for a barbeque...whatever... you as a member of this group may be able to make an activity into one with a purpose. We may also be able to send a representative to speak to your group if this is helpful. So, don't be shy - give it a try! Call our Foundation office - 519-323-3333 Ext 2750 if you wish to explore an idea with help from the Foundation.



Waiting...

This room will soon be history...

Very soon, walls in this waiting room will be demolished to make way for new doorways and temporary offices for our visiting specialists.

This pre-Redevelopment renovation assures that appointments and examinations during the construction of the new Ambulatory Care area will continue as normal ... thanks in advance for your patience during the renovation.

Yes, here is my/our next gift of \$ _____ to the Always Here for You Campaign

Please apply to my/our pledge Make a gift or pledge online: <http://www.alwayshereforyou.ca/>

Cheque enclosed Credit Card _____ Ex date _____ CVN (3-digit on back) _____

Name _____

Change the address to _____

Phone _____

I have a plan for helping the Campaign Committee! Contact me at the phone number (above).

Thank you for your continuing support of the Always Here for You Campaign.



An income tax receipt will be issued for this gift. Spending of funds is confined to projects approved by The Mount Forest Louise Marshall Hospital Foundation. Gifts for approved projects are used as designated. When the project is fully funded, surplus funds will be applied to other projects.